

QUICK GUIDE FOR SAMPLE COLLECTION

Exhaustive instructions
for use available at
www.iai-test.de.

BEFORE SAMPLING:

- ▶ Remove supragingival plaque and dry the sampling point (not professional tooth cleaning).
- ▶ Please note that extensive bleeding and/or pus discharge can falsify the analysis result.
- ▶ The use of antibacterial mouthwash solutions immediately before sampling should be avoided.

CONTENTS:

1 x order form

1 x test tube

1 x set of paper points

1 x security seal

1 x quick guide

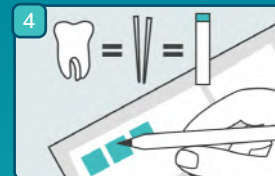
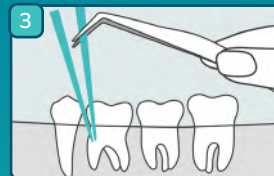

1. Order

Fill in all of the order form fields in clearly legible form using a ballpoint pen. Please note the test number of the order in your documents.

2. Preparation

Pick up the paper points and select the sampling point. Sampling must always be carried out using **exactly two paper points from the deepest pocket** of the periodontium.

***Note: Analysis only possible if exactly two paper points are sent in.**

3. Sampling

Use sterile tweezers to insert two paper points down to the bottom of each gingival sulcus, leave them there for 10-15 seconds and transfer them to the enclosed test tube.

4. Summarisation

Note the sampling point and clinical information on the order form.

5. Shipping

Send in the sample and the order form postage-paid in the PadoBiom® sampling set and obtain your result online (after registration) and by post (if desired).